

Number: GO-08/001		Page 1 of 3
Owner Ministry of Justice - Controller of Surveys	Manual Surveys	Last Revision
Policy Name Intersecting DPI Farm Yard Sites	Effective Date May 22, 2008	Revised Date

Policy Statement:

The procedures described in the following examples shall be followed when a surveyed boundary intersects the line containing the monument that was established on a Descriptive Plan Type I (DPI) Farm Yard Site.

Example A

- The status of the monument, previously established on the corner of the DPI Farm Yard Site, shall be shown on the new plan. A standard iron post shall be established at the intersection of the monumented limit of the DPI Farm Yard Site with the limit of the new survey.
- Angles and distances shall be shown on all sides of the intersecting point on the new plan of survey.

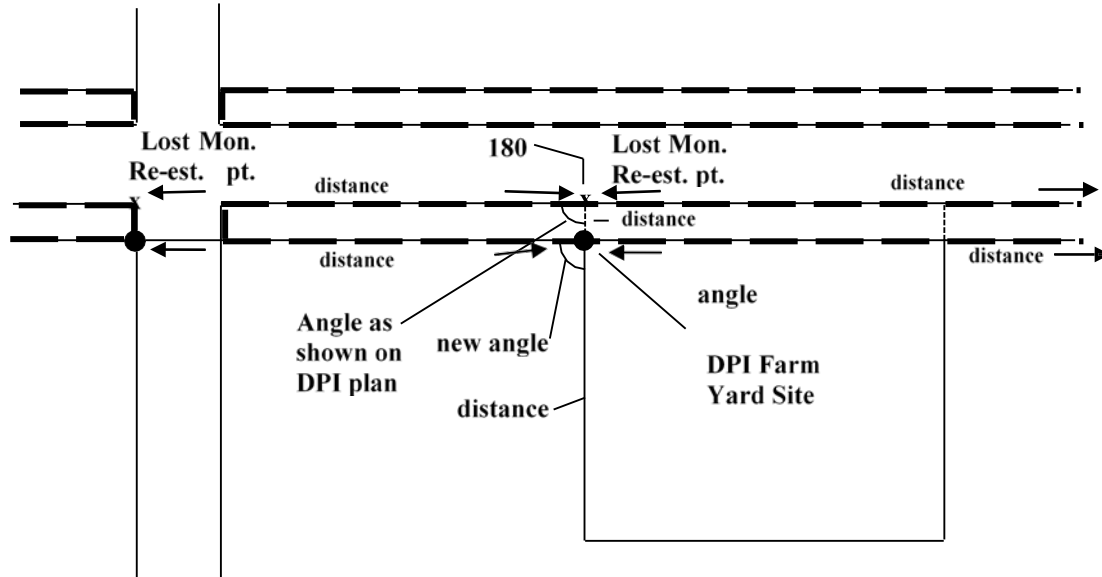

Example B

- Where the unmonumented limit of the new survey intersects the DPI Farm Yard Site, a standard iron post shall be established on the limit of the new survey referencing the intersection point.
- Angles and distances shall be shown on all sides of the intersecting point on the new plan of survey.

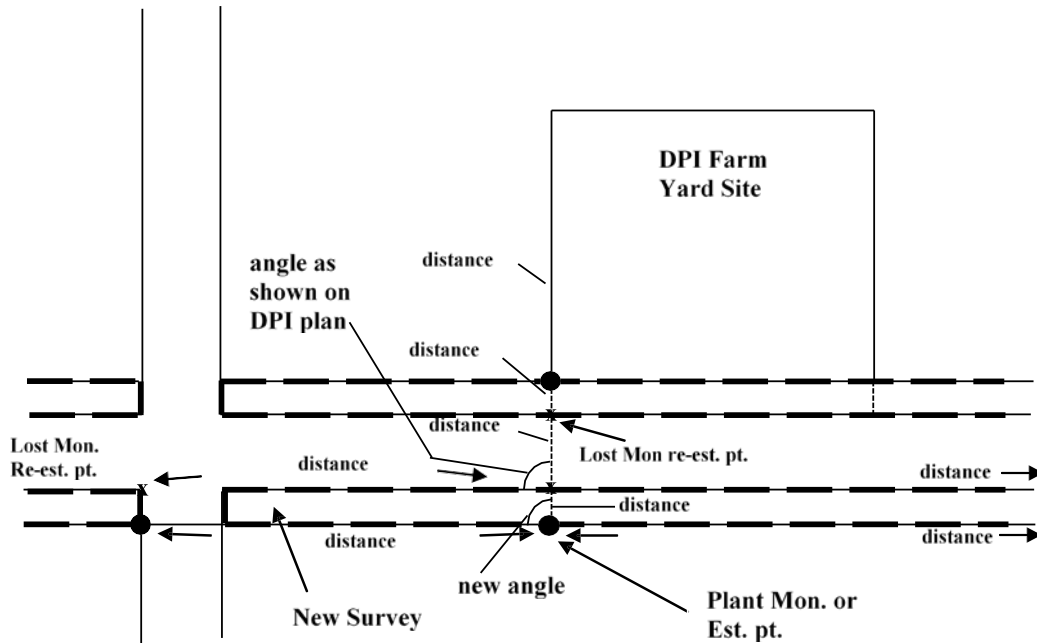
**Example C**

- Intersections are not required if the original corner monument on the DPI Farm Yard Site is not affected by the new survey

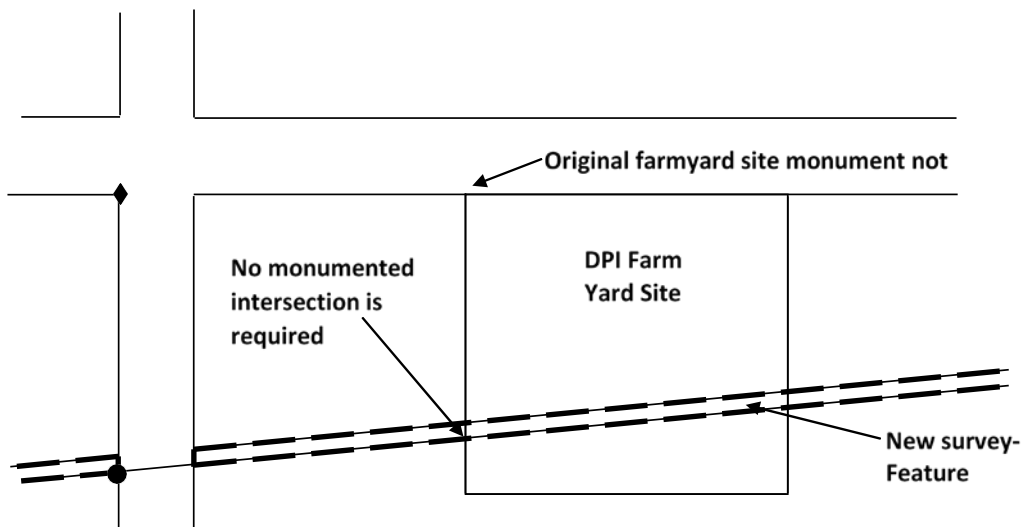

Purpose:

With the increasing number of Descriptive Plan Type I Farm Yard Site surveys, there will be occasions where a new survey intersects the farm yard site. With the requirement for a standard iron post to be established on one corner of the farm yard site, there is a question as to whether this monument dictates that limit of the parcel to be a surveyed line or is the whole parcel considered a descriptive parcel and as such requires no monumented intersections.

It has been determined that the owner(s) of the farm yard site are entitled to a standard iron post marking or referencing the corner of their property. This policy will ensure that a minimum of one survey monument will exist on the farm yard site after surveyed improvements/easements are made which may affect the monumented corner of the farm yard site.

Monumented intersections are not required if the surveyed improvements/easements do not affect the monument marking the corner of the DPI Farm Yard Site.

This policy describes how to deal with various situations.

Approved By: Controller of Surveys

Date: May 22, 2008