

Policy and Procedure: Monumentation Requirements for Establishing Legal Subdivisions

Number: GO-05/005		Page 1 of 4
Owner Ministry of Justice - Controller of Surveys	Manual Surveys	Last Revision
Policy Name Monumentation Requirements for Establishing Legal Subdivisions	Effective Date May 25, 2005	Revised Date

Policy Statement:

All corners that are required, as part of the survey process for establishing legal subdivisions or establishing a parcel on a boundary of a legal subdivision must be marked with standard monuments. In situations where a monument cannot be established, a statement must be included on the plan indicating the reason why.

(See Scenarios A, B and C)

Scenario A: Required monumentation when establishing legal subdivision boundaries

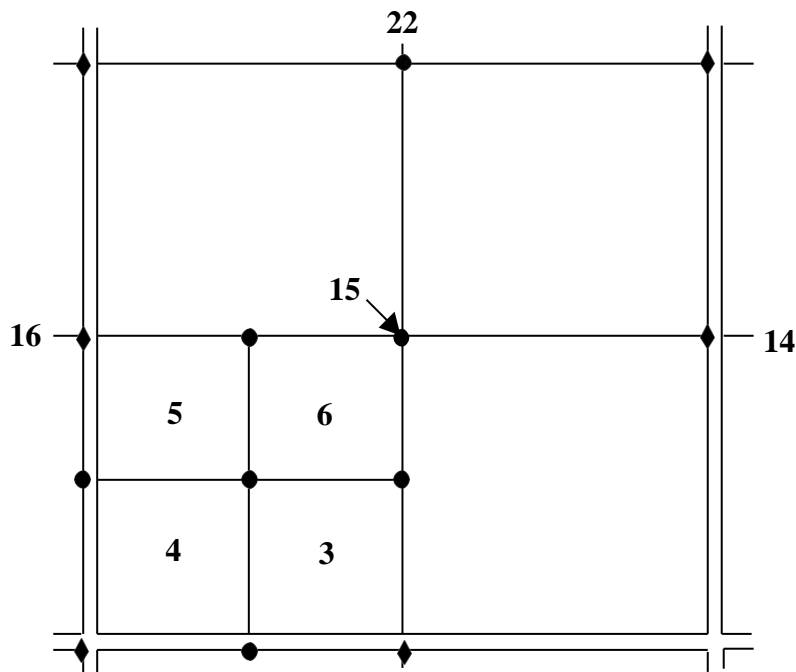

Scenario B: Minimum requirements for monumentation when establishing a parcel on a legal subdivision boundary where there are no deflections at the quarter section monuments.

Example B1:

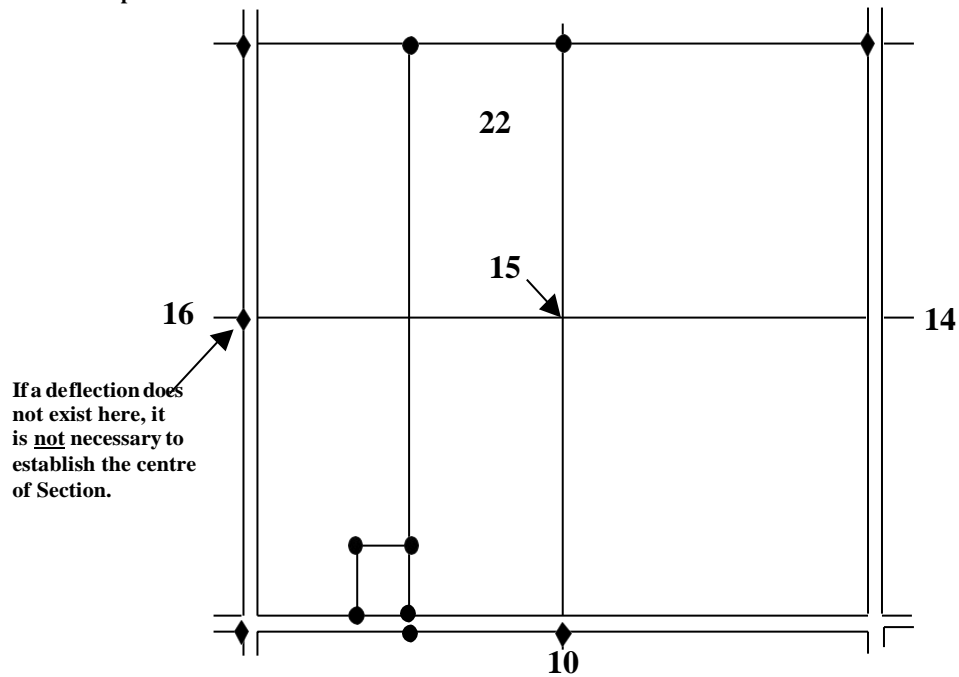

Example B2:

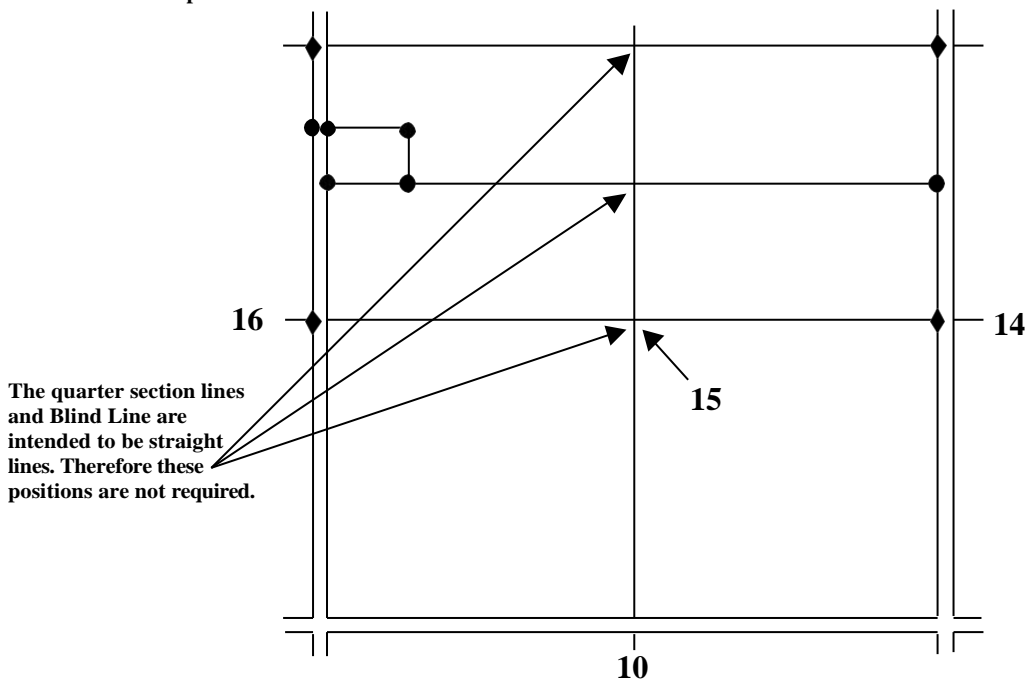

Scenario C: Required monumentation when establishing a parcel on a legal subdivision boundary where deflections exist at the quarter section monuments.

Example C1:

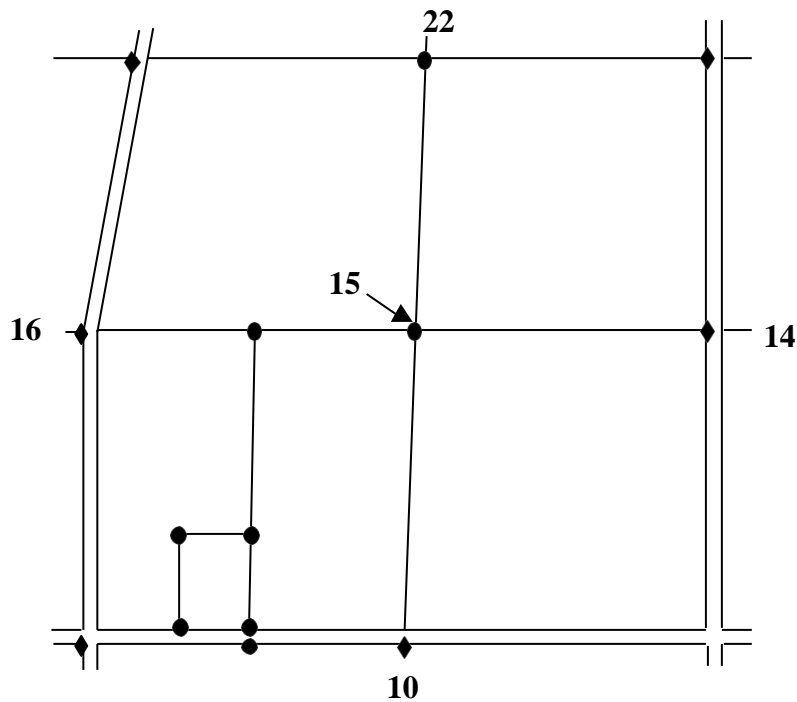

Example C2:

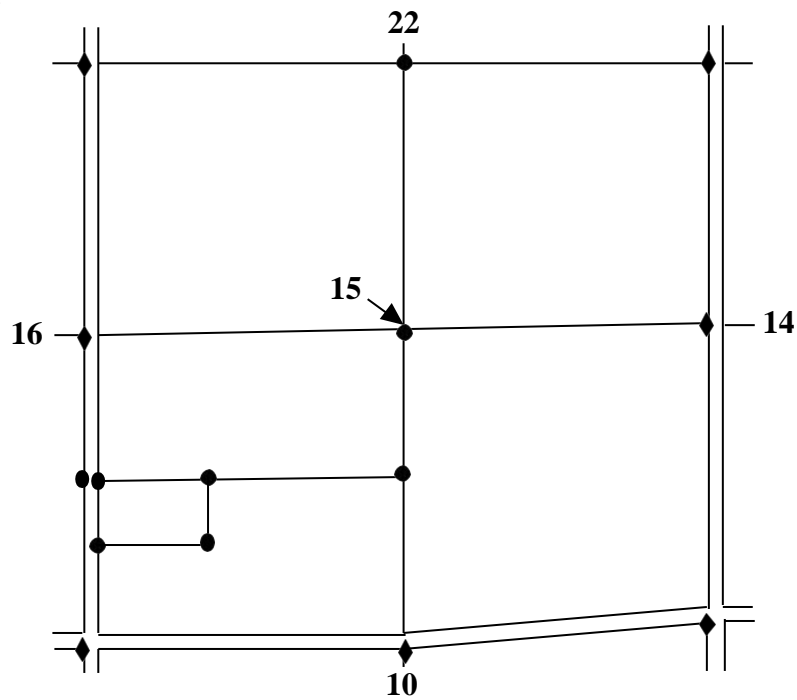

Purpose:

The procedures for determining the boundaries of a legal subdivision (LS) have been a commonly accepted survey practice in the past. First, the section is divided into quarter sections and then the quarter sections are divided into legal subdivisions, which are actually quarters of quarter sections. There has been inconsistency with regard to the monumentation that is required when a LS boundary is surveyed to determine the actual LS or when a parcel is surveyed that has a boundary along a LS boundary.

This policy has been developed in consultation with the Saskatchewan Land Surveyors Association Practice Committee, Controller of Surveys and ISC Surveys and Mapping.

This policy provides land surveyors with common requirements for monumentation.

Approved By: Controller of Surveys

Date: May 25, 2005